

# SUSPENSIONS SET

## FOR PAUL MUNBY LOTUS 63

1/20 scale kit

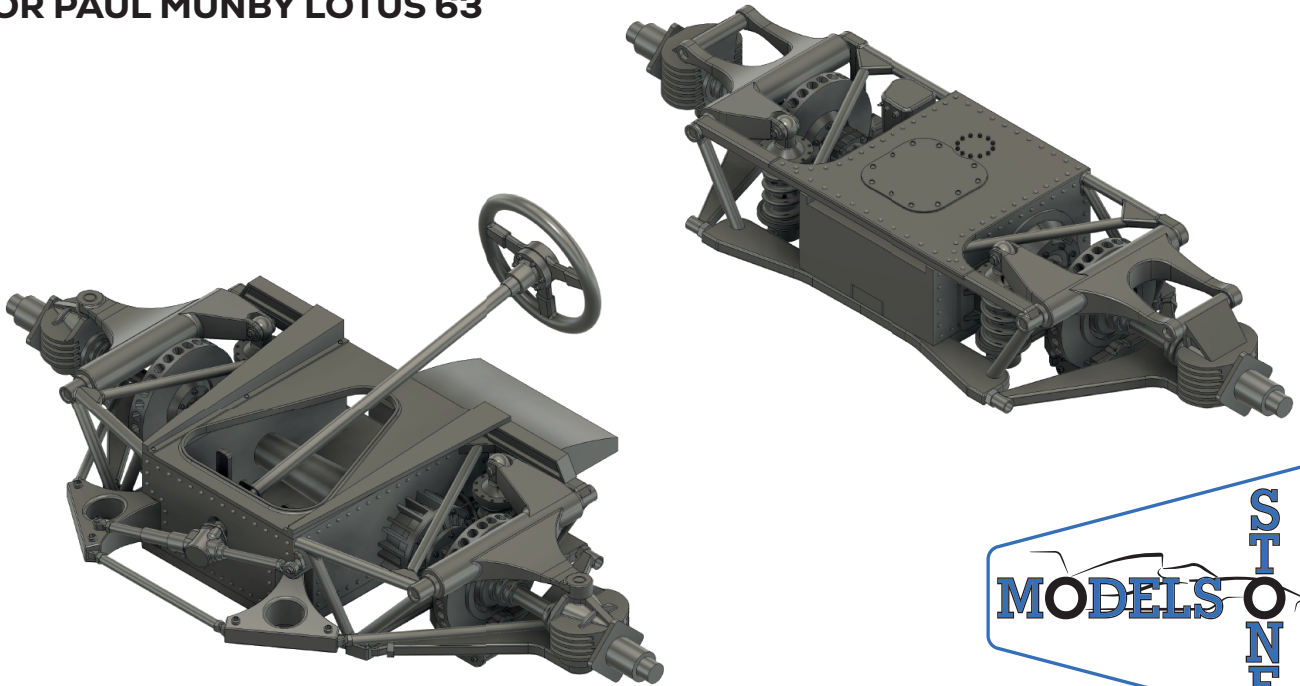

MODELS  
STONE

# ASSEMBLY INSTRUCTIONS



## PARTS DETAIL

### ● Resin Parts

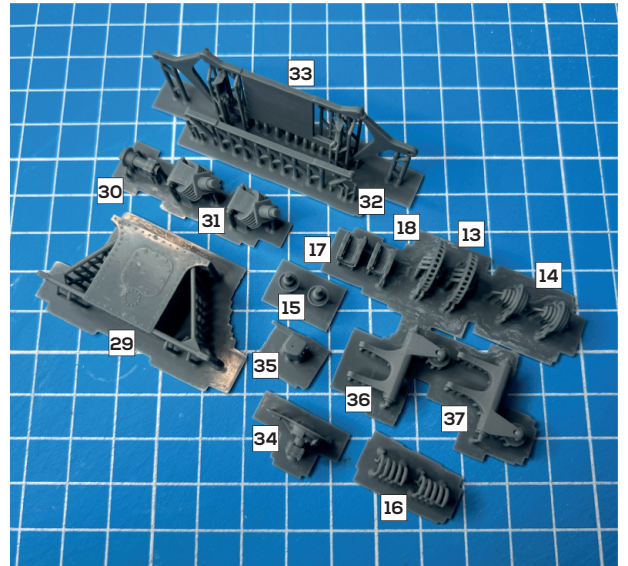
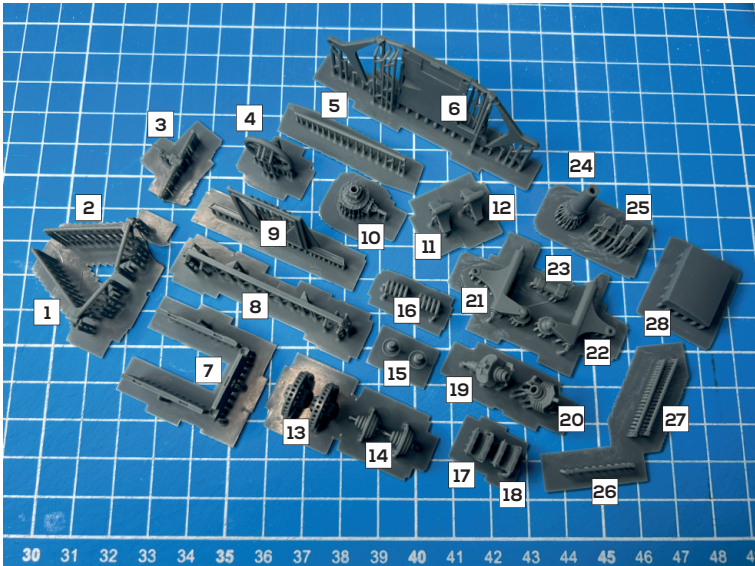

## ⚠ CAUTION

- Read carefully and fully understand all instructions before assembly.
- Extra care should be taken when using tools avoid personal injury.
- When using paint and cement (not included) read and follow their instructions.
- Assemble the kit away from the reach of children.
- Keep all parts and vinyl bags away from children.

A065/2024

## IMPORTANT INFORMATIONS

- The kit is made by 3D print resins.
- Don't use Resin Wash.
- Thin resin parts are easy to deform. Carefully adjust with a hair dryer or hot water at 60°C or higher. Don't boil resin parts.
- Don't immerse in water, hot water, or solvents for a long time. Absorbs water and solvents.
- After washing with water, dry completely.
- Smooth the parts by sand papers and nippers.
- Various type of putty are available.
- Use epoxy or CA glue only.
- Please try temporarily assembly the kit before applying any adhesives.
- Recommend to apply primer surfacer before painting.
- Decals are not pre-cutted. They must be cut individually.
- Don't rub the decals to much, it's easy to scratch.
- If you use any decal softer or setter practice at a not needed decal piece.

1

Cut the  $\varnothing 1.6\text{mm}$  brass rod (kit part) to a length of approx. 68mm to create the drive shaft.

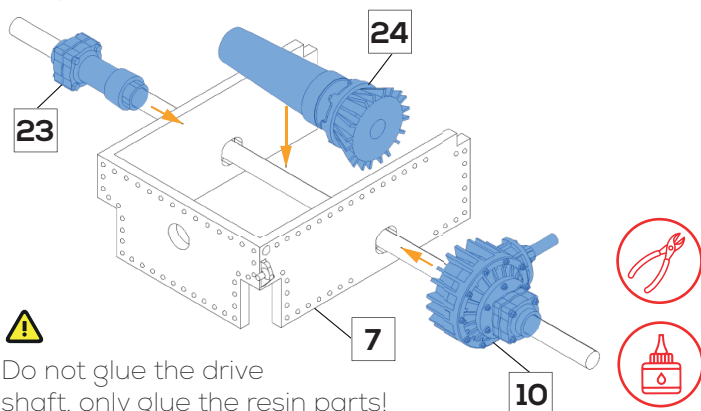

2

⚠ Check cutting view to glue in right direction.

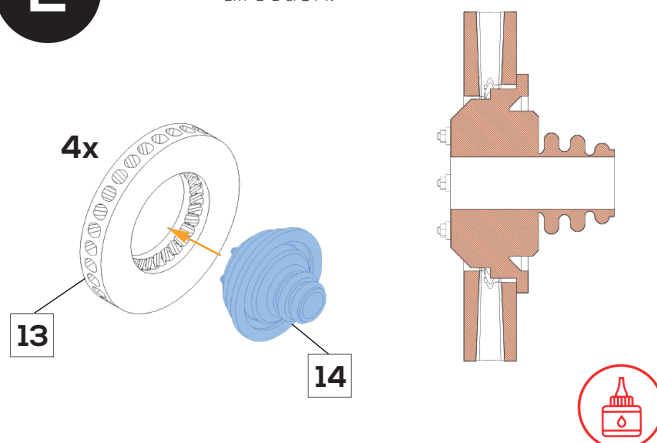

3

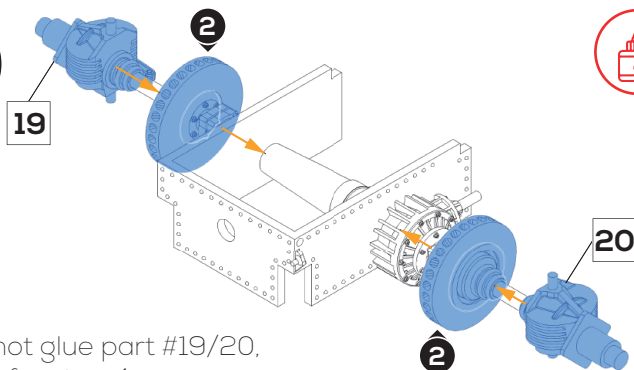

4

⚠ Do not glue part #11/12, wait for step 5/7.

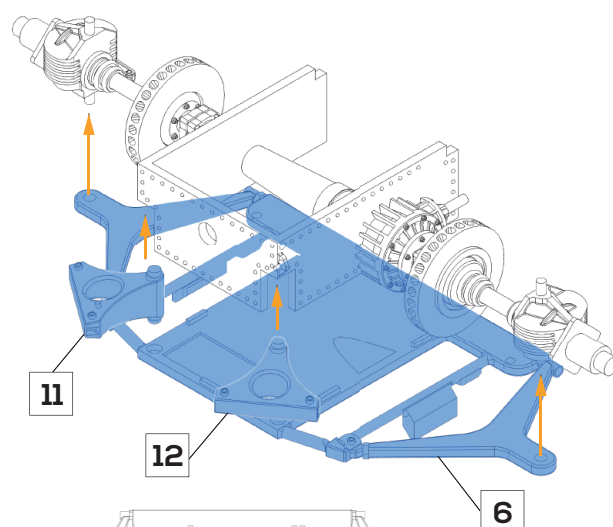

5

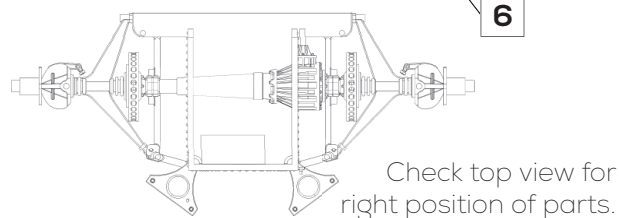
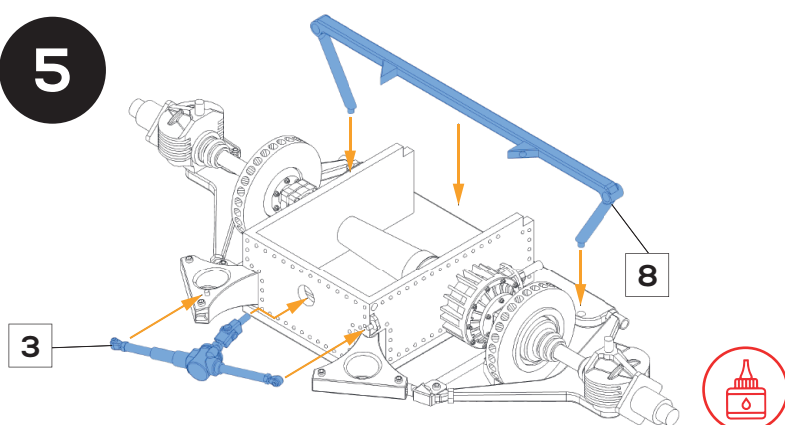

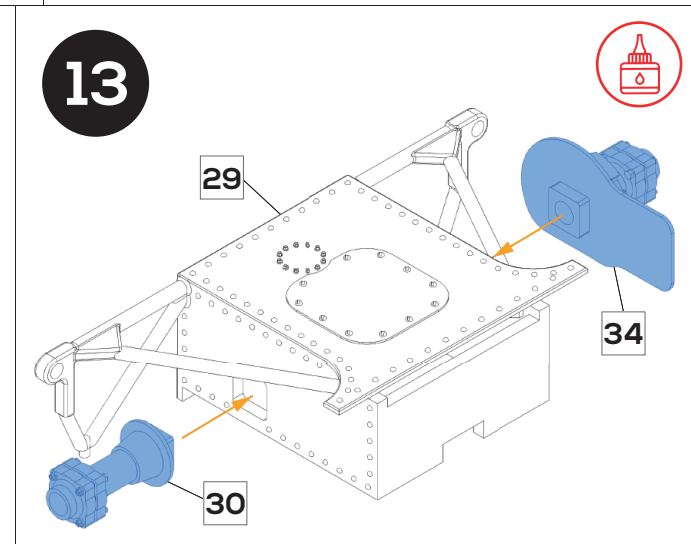
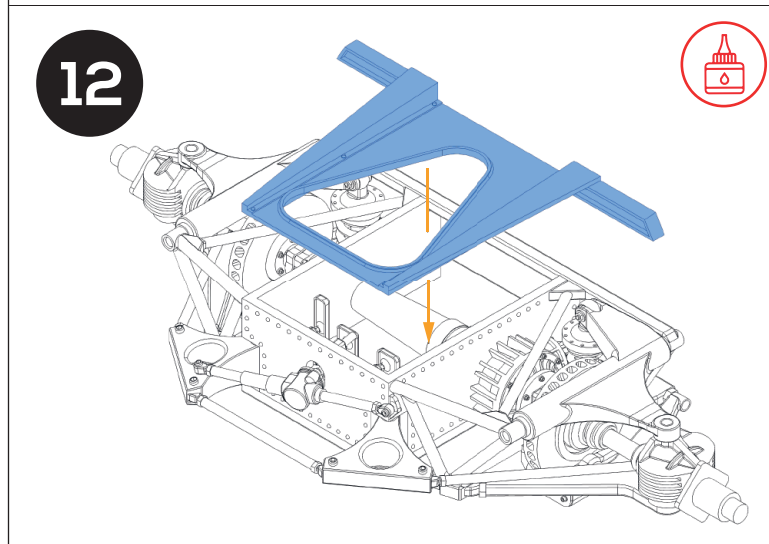
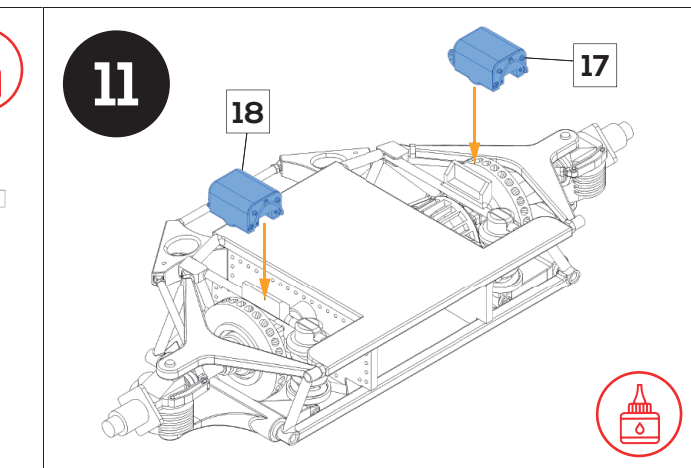
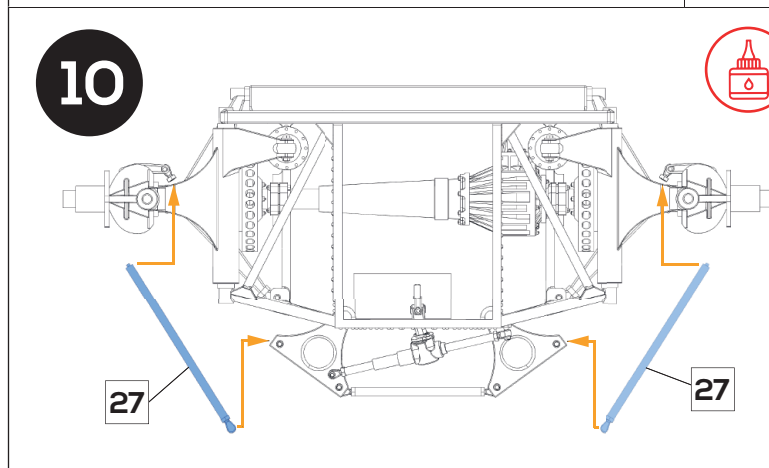
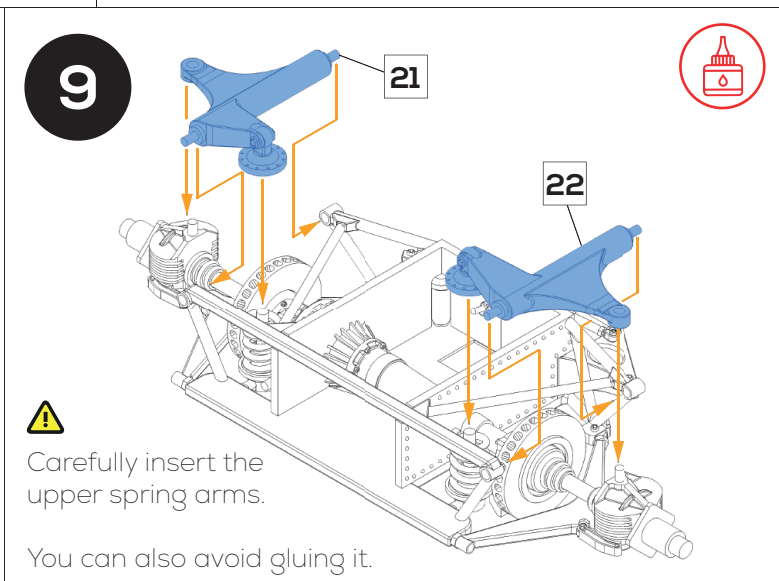
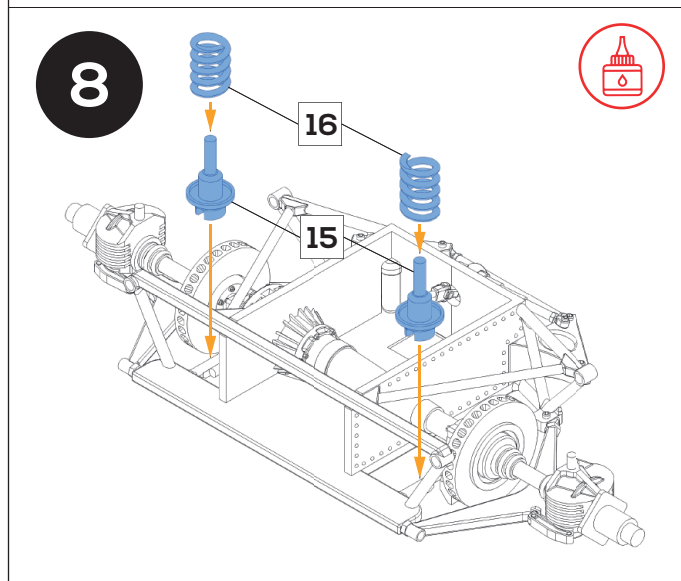
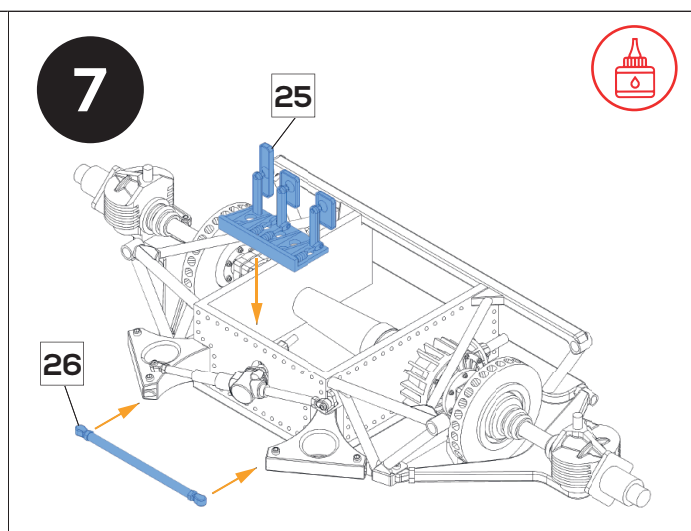
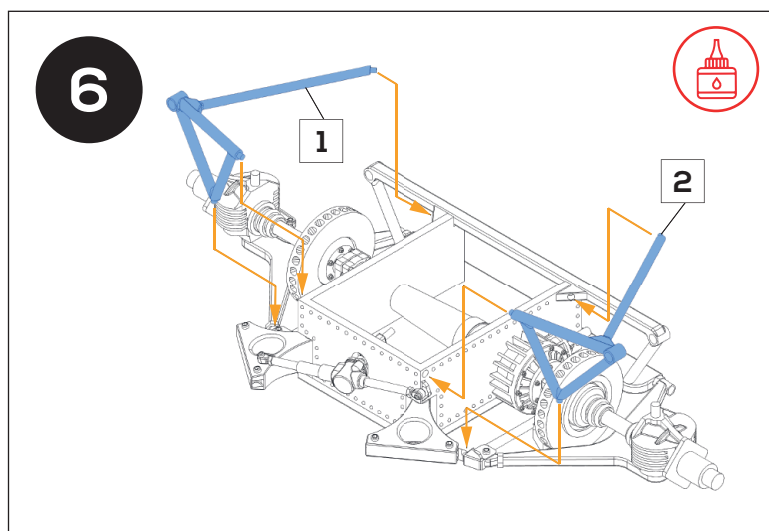

14

Cut the  $\varnothing 1.6\text{mm}$  brass rod (kit part) to a length of approx. 68mm to create the drive shaft.

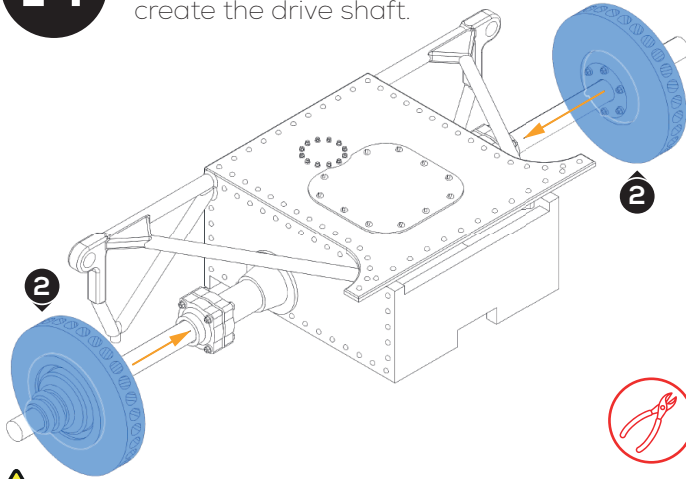

Do not glue the drive shaft, only glue the resin parts!



15

Do the same on opposite side.

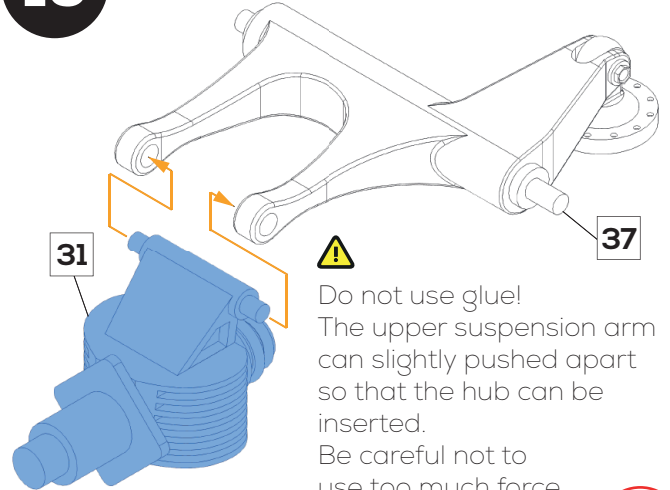

Do not use glue!  
The upper suspension arm can slightly pushed apart so that the hub can be inserted.  
Be careful not to use too much force.



If necessary, shortening the pins can help.

16

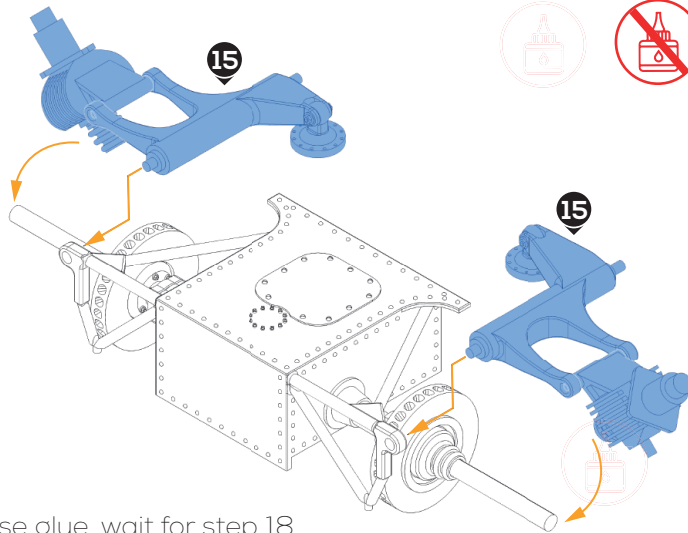

Do not use glue, wait for step 18.



17

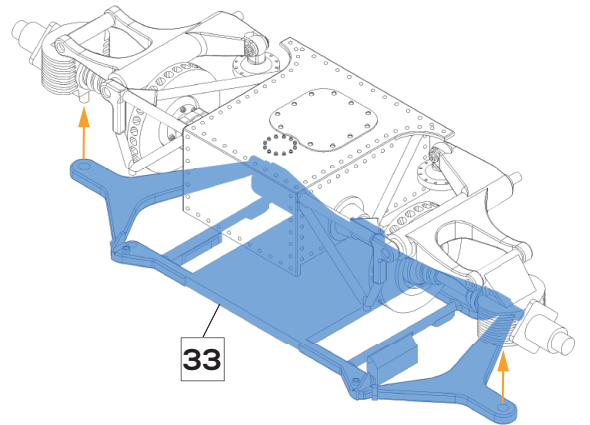

18

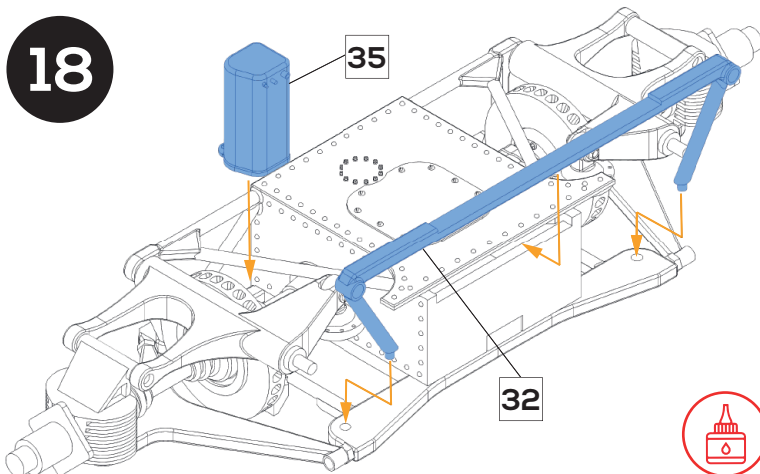

19

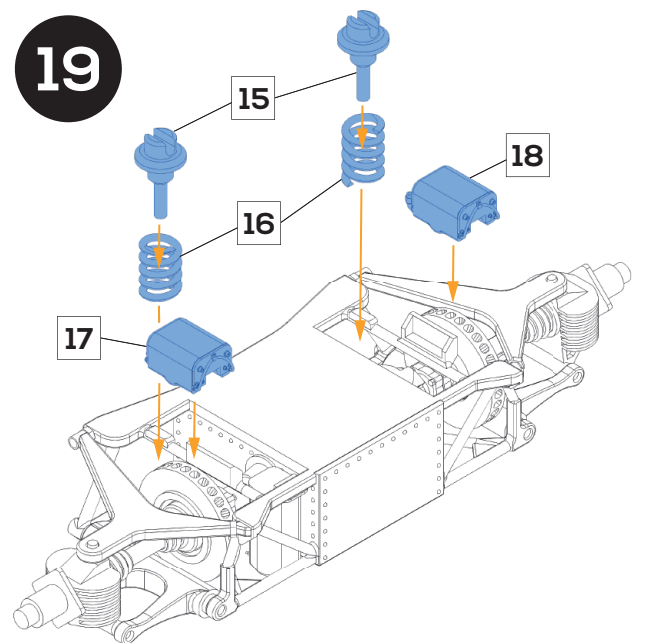

Just put parts 15/16 together, then assemble both parts and finally glue part 15 to the floor.



Explanation of symbols:



Use a file or sandpaper

Drill

Glue

Do not glue

Use a knife or scalpel

Don't use a knife or side cutter

Use a scissors

Use a side cutter

Screw

## BASE KIT ADJUSTMENTS

The following pictures show adjustments to the base kit for an easy installation and a few additional changes for later detail-up sets.

### • body part

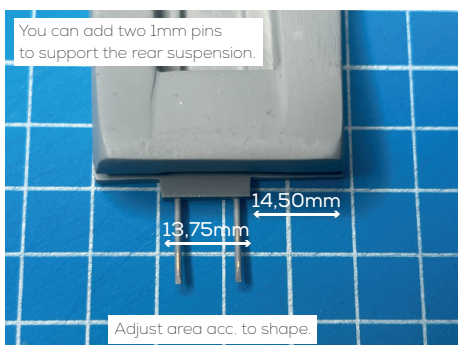
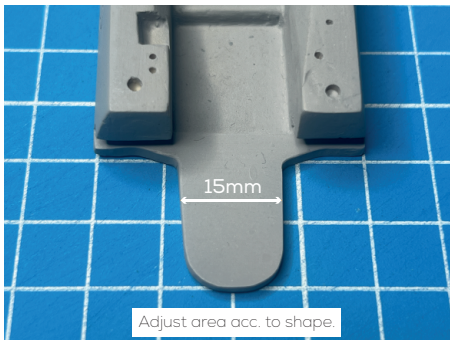
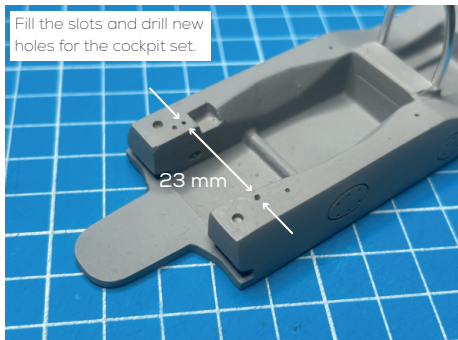

### • cockpit cover

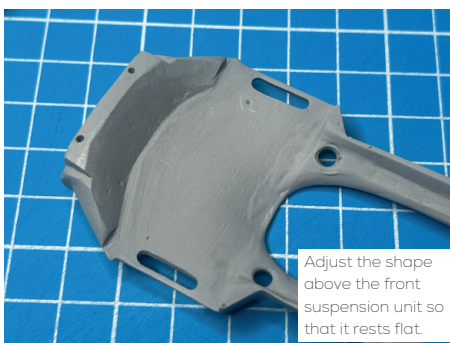
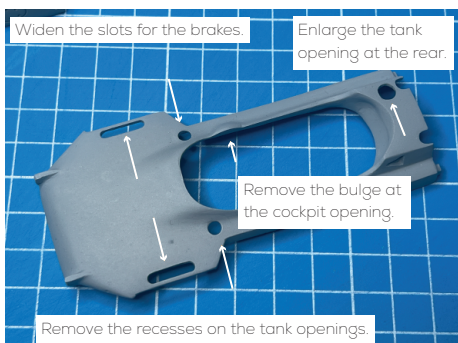

### • engine cover

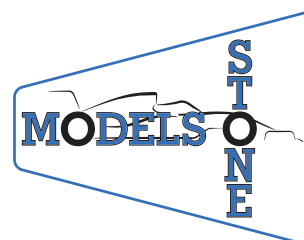

COPYRIGHT © 2024  
by STONE Models