

# JORDAN 191

DETAIL-UP SET

1/20 scale kit



## ASSEMBLY INSTRUCTIONS



### PARTS DETAIL

#### ● Resin Parts

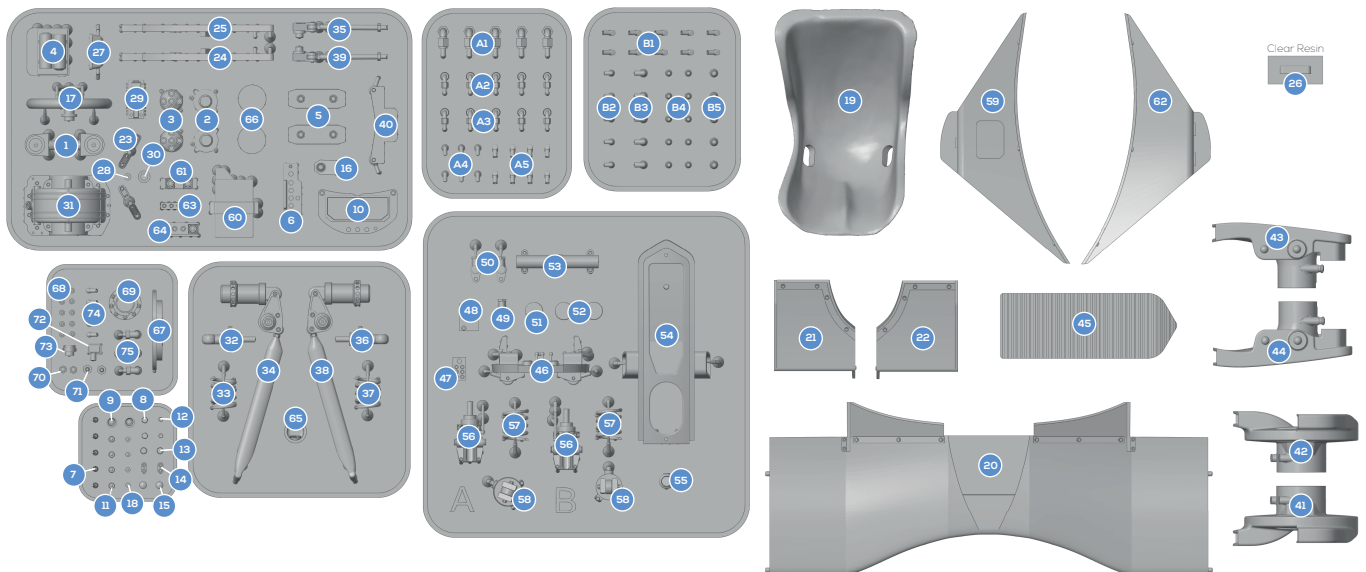

### IMPORTANT INFORMATIONS

- The kit is made by 3D print resins.
- Don't use Resin Wash.
- Thin resin parts are easy to deform. Carefully adjust with a hair dryer or hot water at 60°C or higher. Don't boil resin parts.
- Don't immerse in water, hot water, or solvents for a long time. Absorbs water and solvents.
- After washing with water, dry completely.
- Smooth the parts by sand papers and nippers.
- Various type of putty are available.
- Use epoxy or CA glue only.
- Please try temporarily assembly the kit before applying any adhesives.
- Recommend to apply primer surfacer before painting.

A092/2024

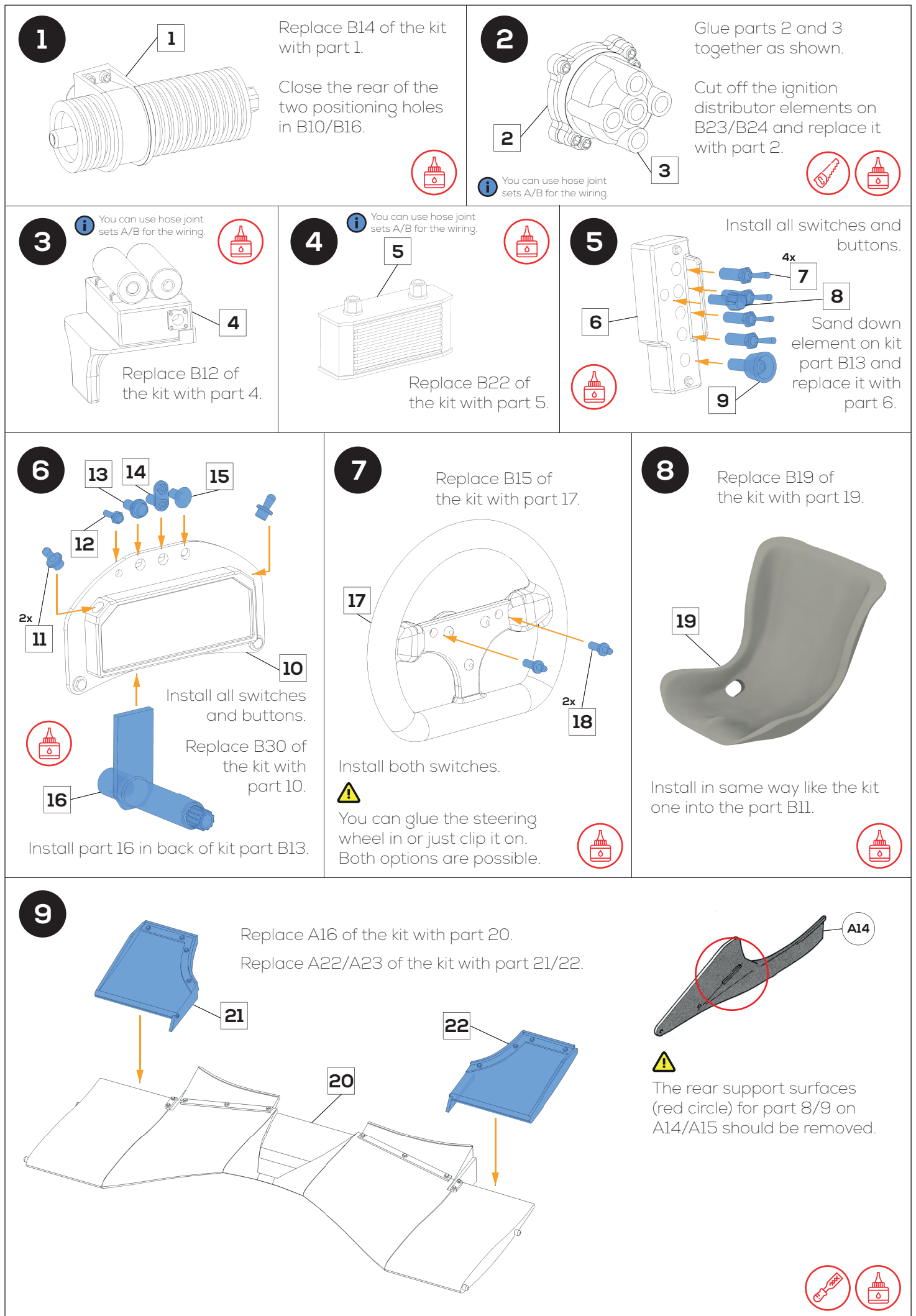

10

**i** You can use hose joint sets A/B for the wiring.

Glue all parts together.

Replace B2 of the kit with part 26/27.



Connect the new assembly unit later to the cut off area in step 11.



11

Cut B10/B16 on this position after it was glued together.

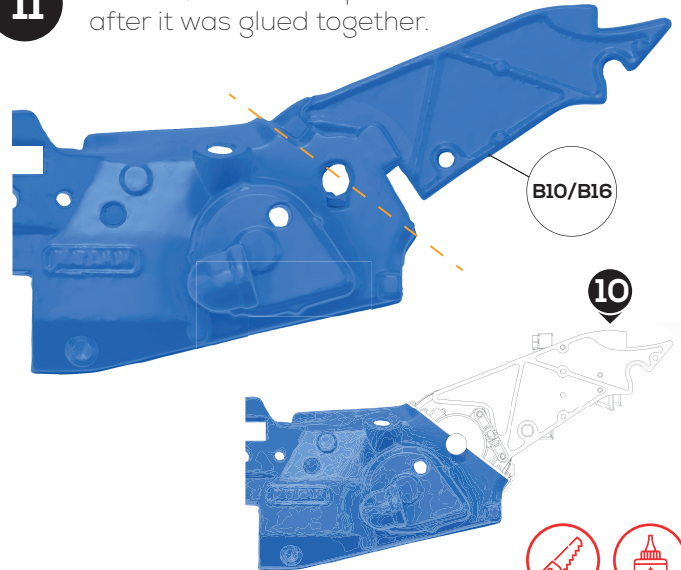

12

Replace C10 of the kit with part 32-34.

(L) 32-35  
(R) 36-39

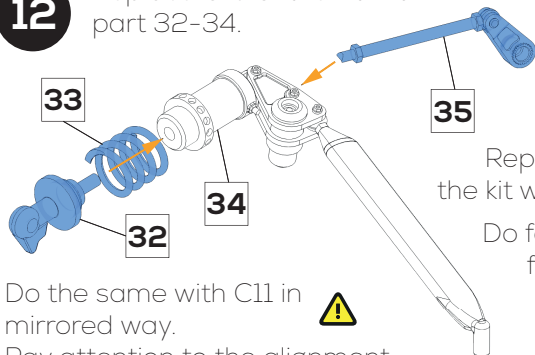

Replace B28 of the kit with part 35.

Do for right side for B29 with part 39.

Do the same with C11 in mirrored way.



Pay attention to the alignment before gluing together.



13

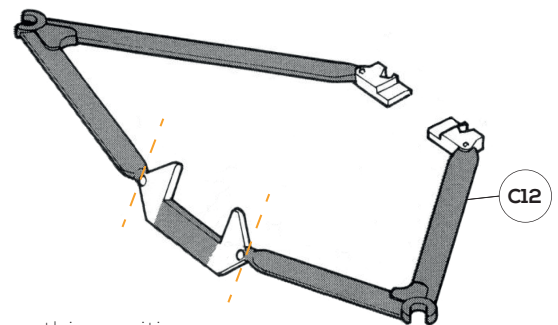

Cut C12 on this positions and drill  $\varnothing 0.6\text{mm}$  holes in cutting surfaces to connect it with part 23.



14

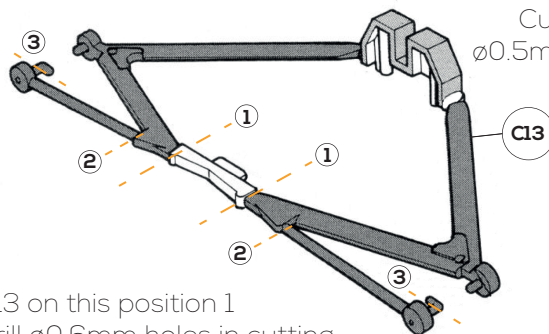

Cut C13 on this position 1 and drill  $\varnothing 0.6\text{mm}$  holes in cutting surfaces to connect it with part 40.

Cut on position 2 and drill  $\varnothing 0.5\text{mm}$  holes in both cutting surfaces. Insert some brass wire (not included) to connect it later.

Cut on position 3 to connect it with part 41/42.

Connect part 35 with gearbox unit from step 11 before further assembly.

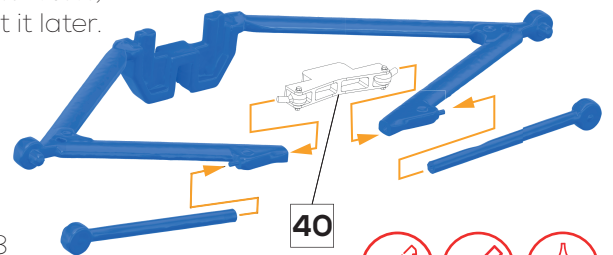

15

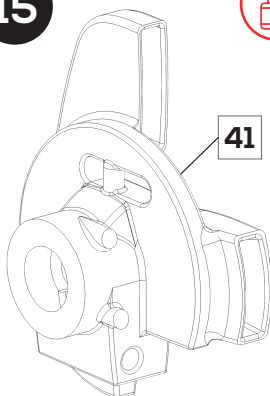

Replace C5/C6 of the kit with part 41/42.

16

Replace C4/C7 of the kit with part 43/44.

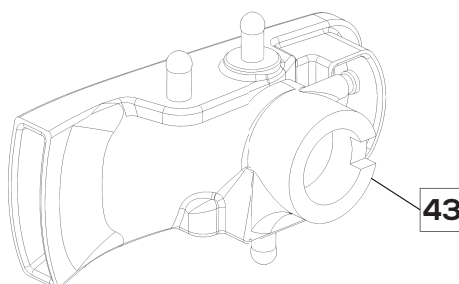

17

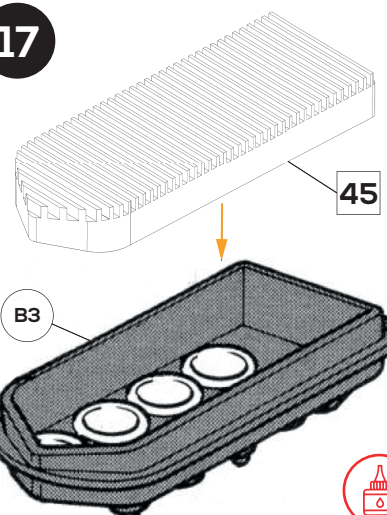

18

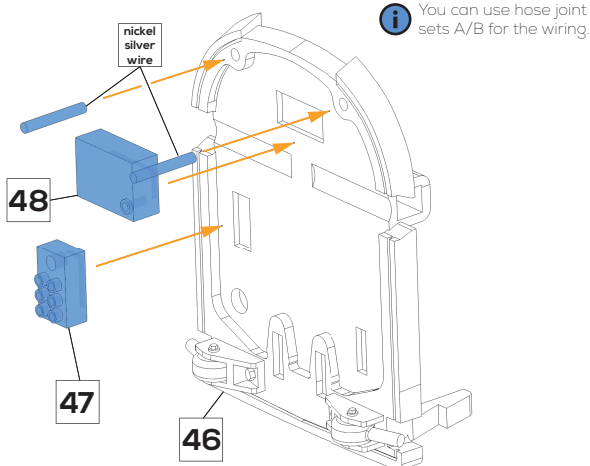

Glue all parts together.  
Use some nickel silver wire (not included).



19

Glue all parts together.

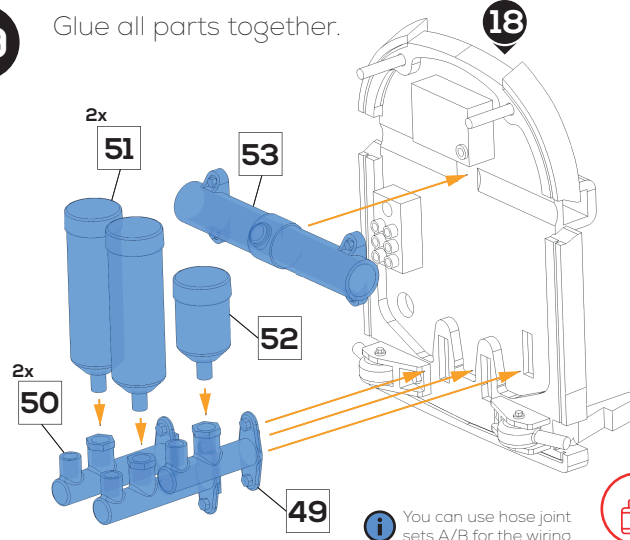

20

2 versions for parts 56-58 are available. Choose one.

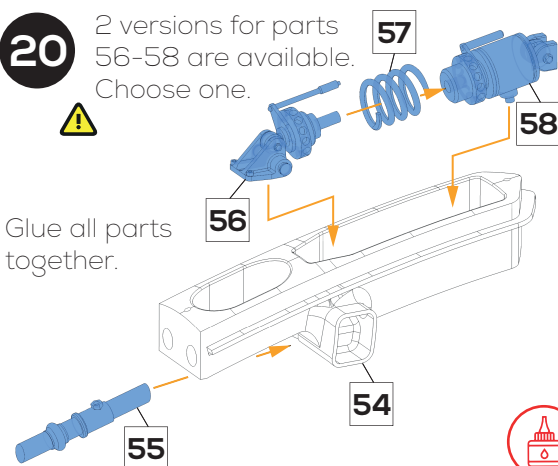

Glue all parts together.



21

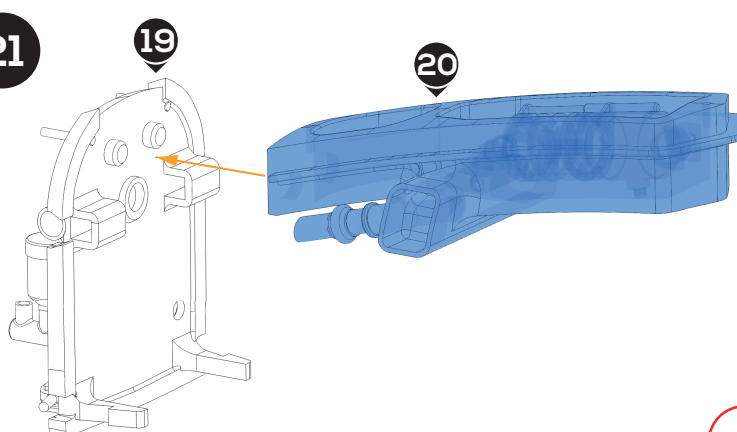

Glue both assembly units together.



22

Install the assembly unit from step 21.

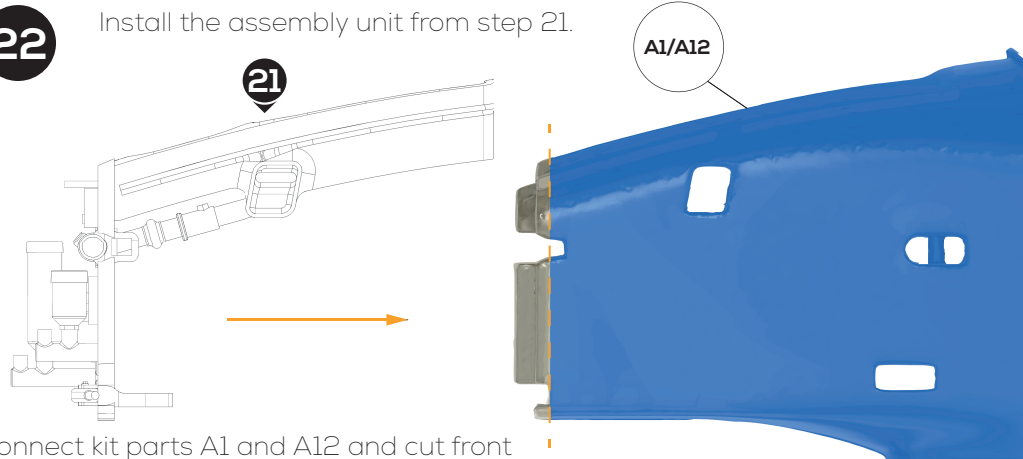

Connect kit parts A1 and A12 and cut front area for about 2.5mm to get the shown shape.

Cut out the blue marked area for installation of the front damper unit.

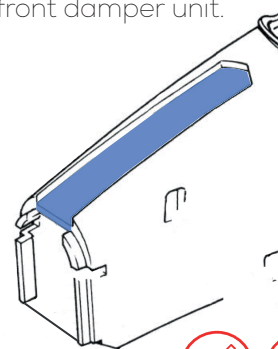

23

Cut C1 on this positions and drill  $\varnothing 0.6\text{mm}$  holes in cutting surfaces to connect it with front unit.

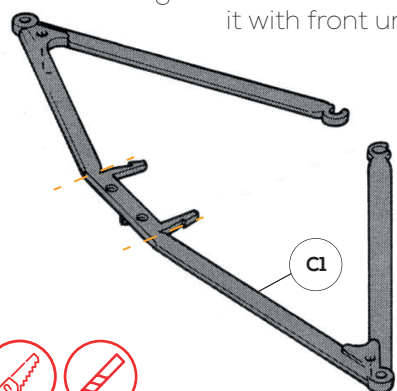

Cut C2 on this positions and test fitment to connect it with front unit.

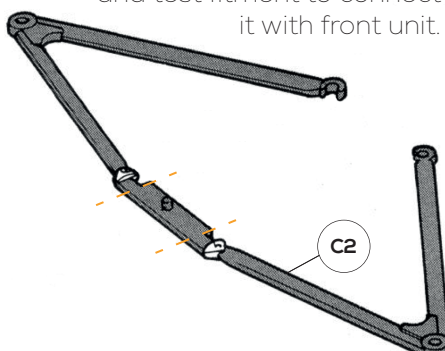

Cut C3 on this position. It is possible to reassemble the parts after installation. Make sure they are aligned correctly.

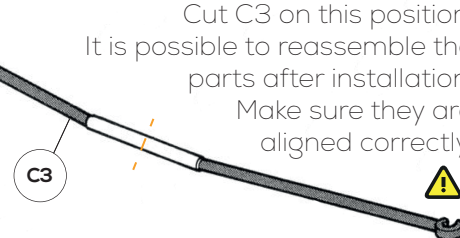

6.85mm

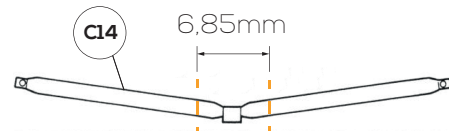

Cut C14 on this positions.





24

60

59



Close holes for B7/B8 in monocoque. These are no longer needed.

61

Replace B6 of the kit with part 62.

Replace B7 of the kit with part 59.

You can use hose joint sets A/B for the wiring.

25

Drill a  $\varnothing 3.0\text{mm}$  hole and insert part 65.

65

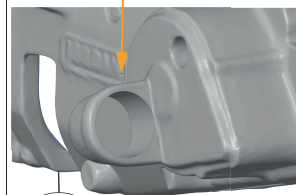

B10/B16



26

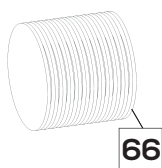

66

Insert part 65 after cutting and glue it back together.

B4/B8

Cut B14/B8 on this positions.



27

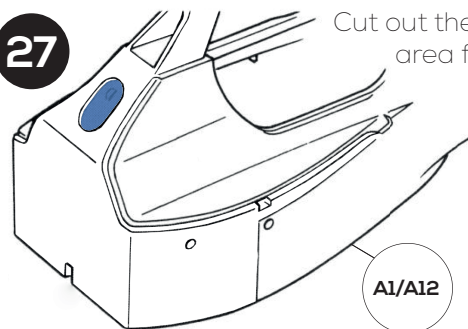

Cut out the blue marked area for installation of part 66.

A1/A12



28

A1/A12

Use a  $\varnothing 0.6\text{mm}$  drill bit.

67

Use the part as a template for drilling the 10 holes.

Install part 66 from the rear.



29

8x

68

Step 1

Install parts 67-74 in 3 Steps.

Step 3

3x

74

2x

75

69

70

72

71

73

Step 2

You can use hose joint sets A/B for the wiring.



## ⚠ CAUTION

- Read carefully and fully understand all instructions before assembly.
- Extra care should be taken when using tools avoid personal injury.
- When using paint and cement (not included) read and follow their instructions.
- Assemble the kit away from the reach of children.
- Keep all parts and vinyl bags away from children.

### Explanation of symbols:



Use a file or sandpaper

Drill

Glue

Use a knife or scalpel

Don't use a knife or side cutter

Use a scissors

Use a side cutter

Screw

Saw



STONE Models

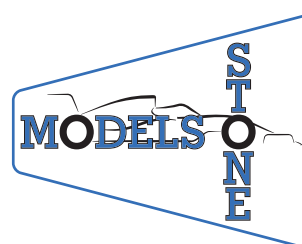

COPYRIGHT © 2025  
by STONE Models



*Thank You!*

---

**FOR YOUR PURCHASE**

Thank you for your order and support me!  
Don't forget to share your experience.